

To All Customers

Rep No.B14035
 November 10, 2014

Fuji Electric FA Components & Systems CO., Ltd.
 Business Planning Division Business Operations Department

Protective Relay QHA Series Notification of Change to Some Functions of Overcurrent Relays

We would like to thank you for your continued patronage of Fuji products.
 We will be changing some products as described below.
 Please review the following information and take appropriate actions.
 Please inform all related sections of your company.

Product names	Overcurrent relay									
Series and series name	QHA Series									
Types	QHA-OC1 QHA-OC2									
Changed parts	Functions of applicable condition setting switch 5									
Details of the change	<p>Functions that can be configured with setting switch 5 will be changed.</p> <p>Products before the change make it possible to select the reset characteristic using setting switch 5 but the minimum time delay operating time cannot be selected.</p> <p>The present change will make it possible to select the minimum time delay operating time, and this makes it impossible to select the reset characteristic.</p> <table border="1" style="margin-left: auto; margin-right: auto;"> <thead> <tr> <th></th> <th>Reset characteristic</th> <th>Minimum time delay operating time</th> </tr> </thead> <tbody> <tr> <td>Before change</td> <td>Instantaneous reset/ inverse time delay Selectable</td> <td>150 mS</td> </tr> <tr> <td>After change</td> <td>Instantaneous reset</td> <td>110 mS/150 mS Selectable</td> </tr> </tbody> </table> <p>* For details of the change, see Attachments 1 and 3.</p>		Reset characteristic	Minimum time delay operating time	Before change	Instantaneous reset/ inverse time delay Selectable	150 mS	After change	Instantaneous reset	110 mS/150 mS Selectable
	Reset characteristic	Minimum time delay operating time								
Before change	Instantaneous reset/ inverse time delay Selectable	150 mS								
After change	Instantaneous reset	110 mS/150 mS Selectable								
Reason for change	To improve the versatility of operating time coordination with the upstream equipment									
Date of production change	Changed products scheduled to be produced from February 2015.									
Attachments	Attachment 1 "QHA-OC1 and OC2 Change Details"									
Notes concerning the change	This change does not have any effect on the external or mounting dimensions of the product.									

QHA-OC1 and OC2 Change Details

(1) Change to front face panel indication

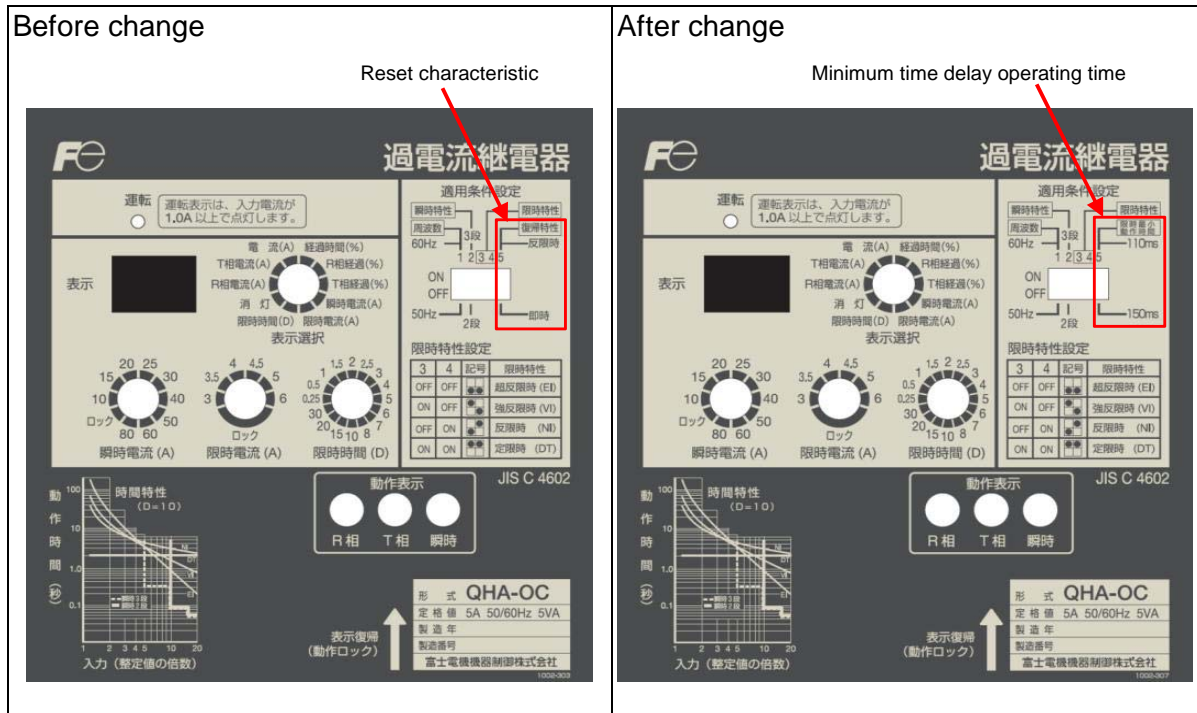

(2) Change to characteristic

